

WELCOME TO THE D'EYNSFORD ESTATE

KEY:

-  Resident Key Fob Access
-  Visitor Intercom Entrance
-  Mary Datchelor Close
-  Don Phelan Close
-  Belham Walk
-  Kimpton Court
-  Kimpton Road
-  Elmington Road
-  Secret Garden
-  (31-39) Secure Access Intercom
-  31-39 Open Access
-  31 Flat Location

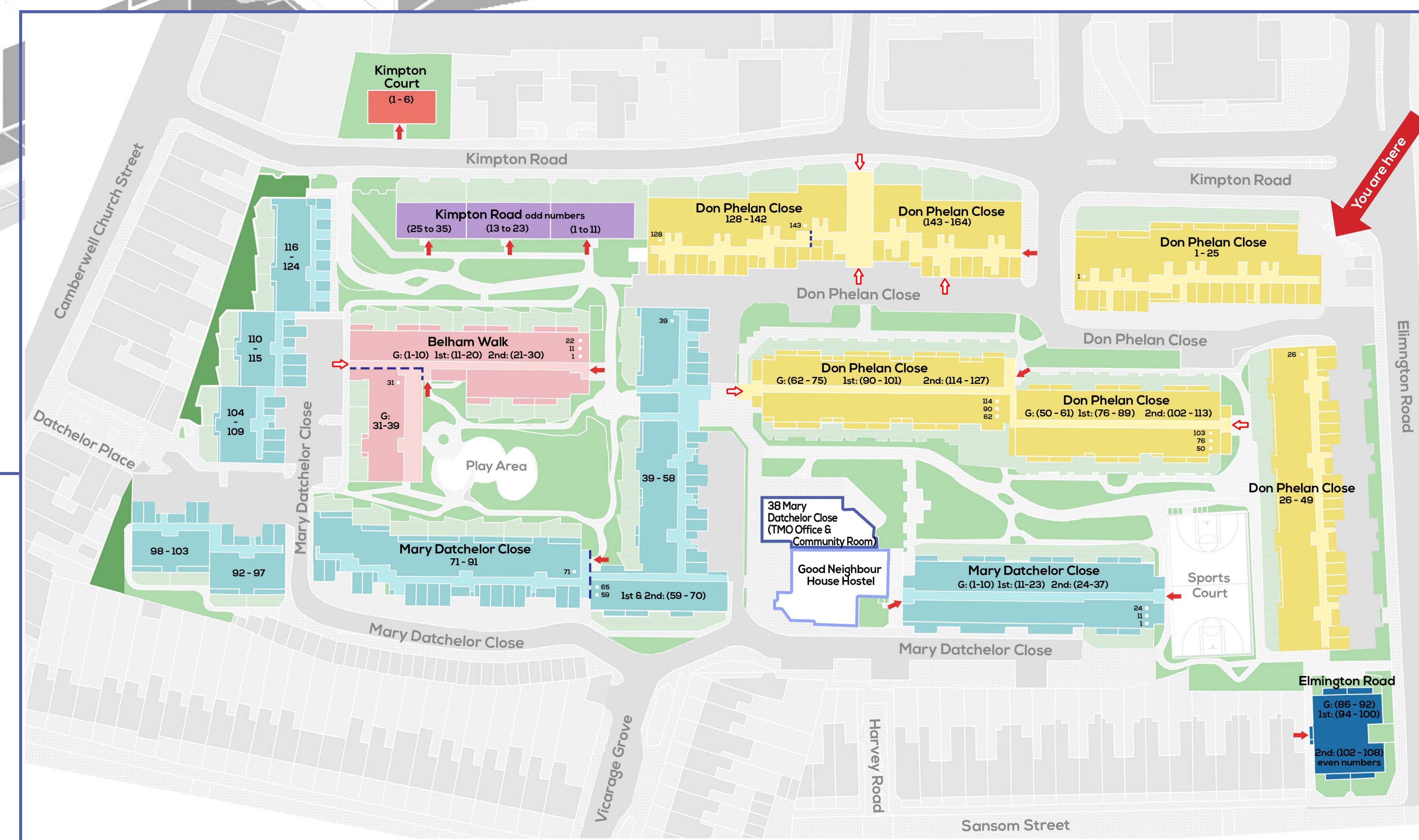
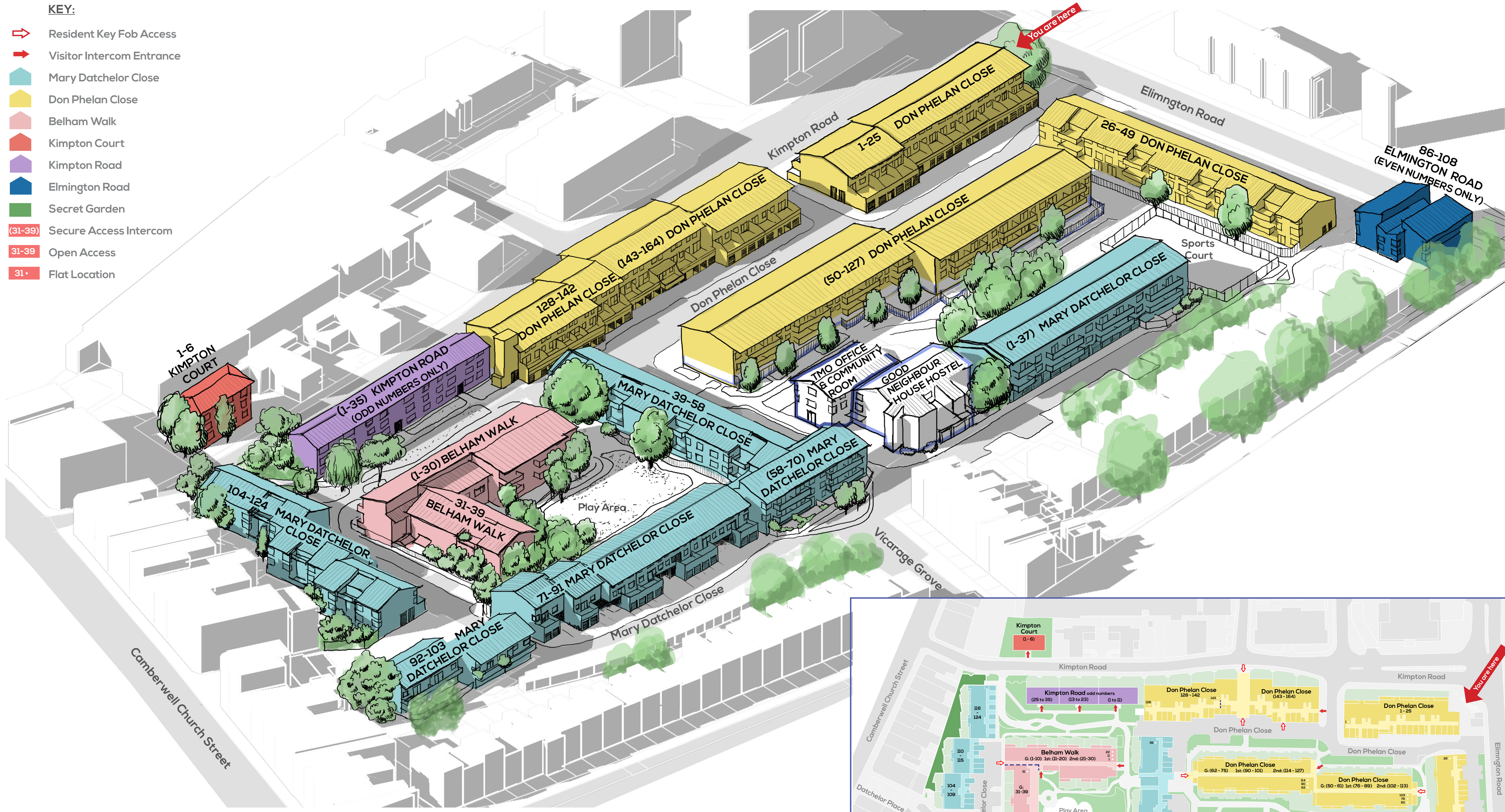

History of D'Eynsford Estate

The D'Eynsford Estate was designed by former RIBA vice-president Clifford Culpin in 1971. It was managed exclusively by Southwark Council until 2015 when D'Eynsford Tenant Management Organisation (TMO) was set up to enable residents on the D'Eynsford Estate to take control of some estate services from Southwark Council.



D'Eynsford Tenant Management Organisation
 Estate Office 38 Mary Datchelor Close, London, SE5 7AX,
 Tel: 020 7525 0745 | TMO@deynsford.org | www.deynsford.org

WELCOME TO THE D'EYNSFORD ESTATE

KEY:

-  Resident Key Fob Access
-  Visitor Intercom Entrance
-  Mary Datchelor Close
-  Don Phelan Close
-  Belham Walk
-  Kimpton Court
-  Kimpton Road
-  Elmington Road
-  Secret Garden
-  (31-39) Secure Access Intercom
-  31-39 Open Access
-  31 Flat Location

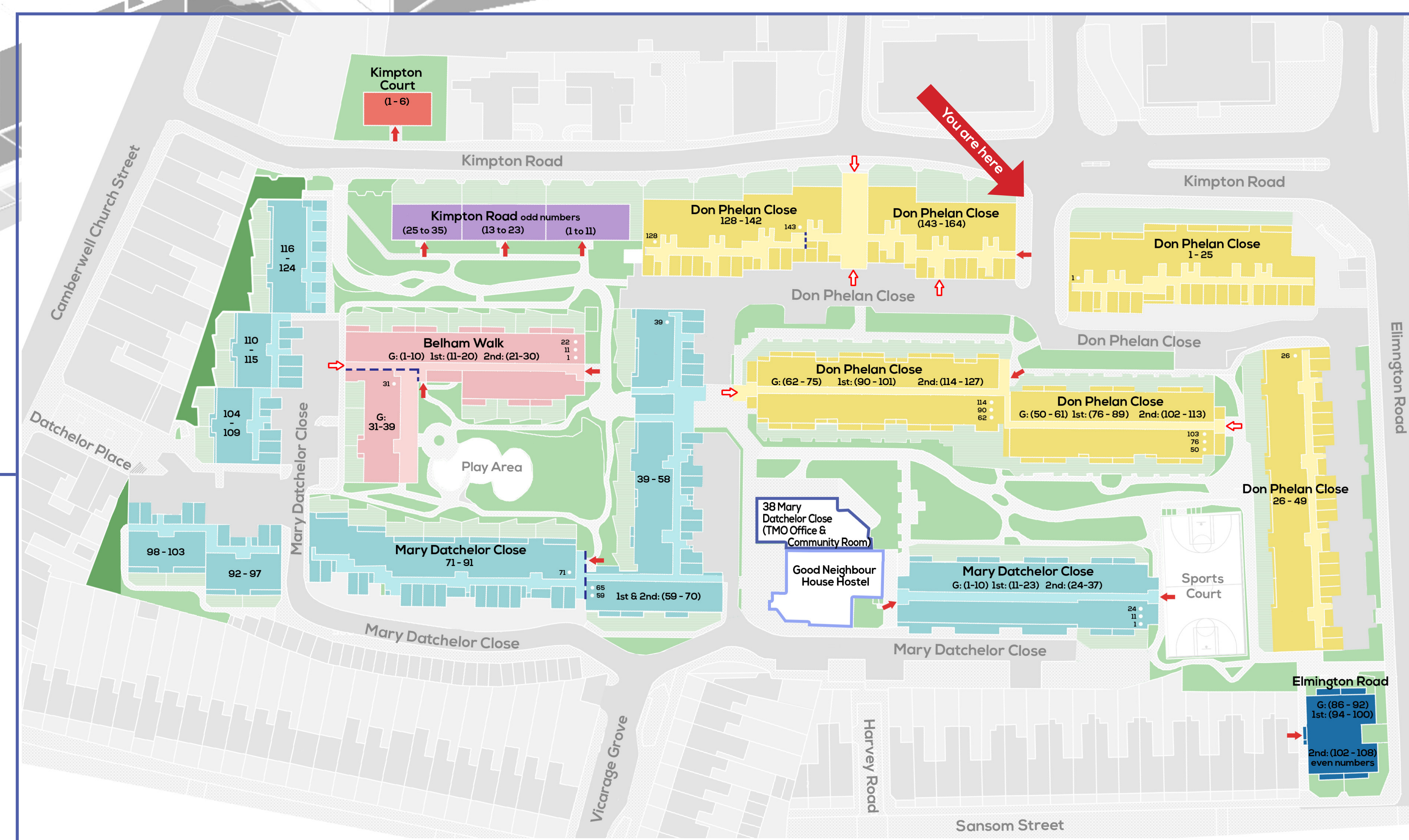
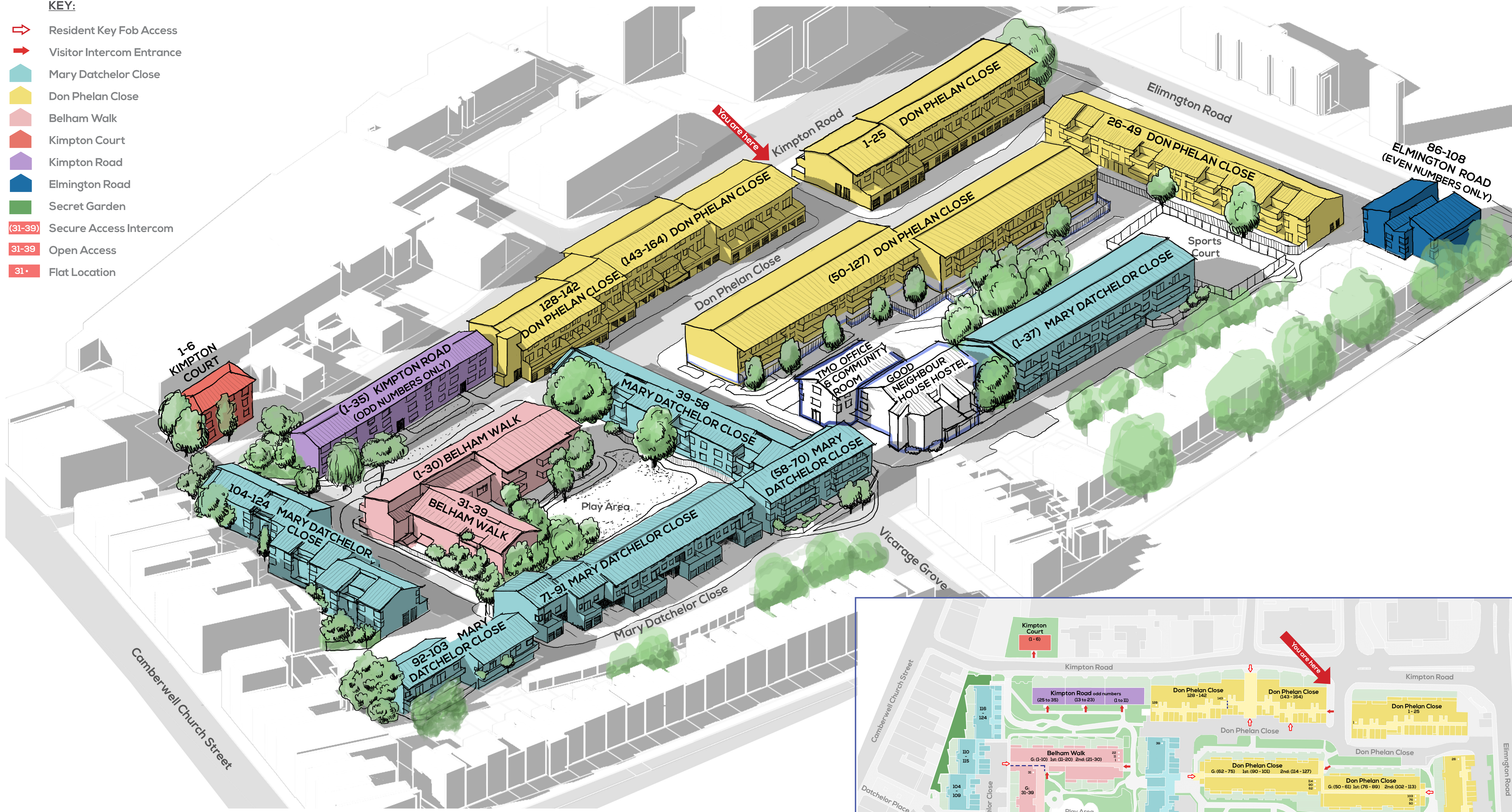

History of D'Eynsford Estate

The D'Eynsford Estate was designed by former RIBA vice-president Clifford Culpin in 1971. It was managed exclusively by Southwark Council until 2015 when D'Eynsford Tenant Management Organisation (TMO) was set up to enable residents on the D'Eynsford Estate to take control of some estate services from Southwark Council.

D'EYNSFORD



D'Eynsford Tenant Management Organisation

Estate Office 38 Mary Datchelor Close, London, SE5 7AX,
Tel: 020 7525 0745 | TMO@deynsford.org | www.deynsford.org

WELCOME TO THE D'EYNSFORD ESTATE

KEY:

-  Resident Key Fob Access
-  Visitor Intercom Entrance
-  Mary Datchelor Close
-  Don Phelan Close
-  Belham Walk
-  Kimpton Court
-  Kimpton Road
-  Elmington Road
-  Secret Garden
-  (31-39) Secure Access Intercom
-  31-39 Open Access
-  31 Flat Location

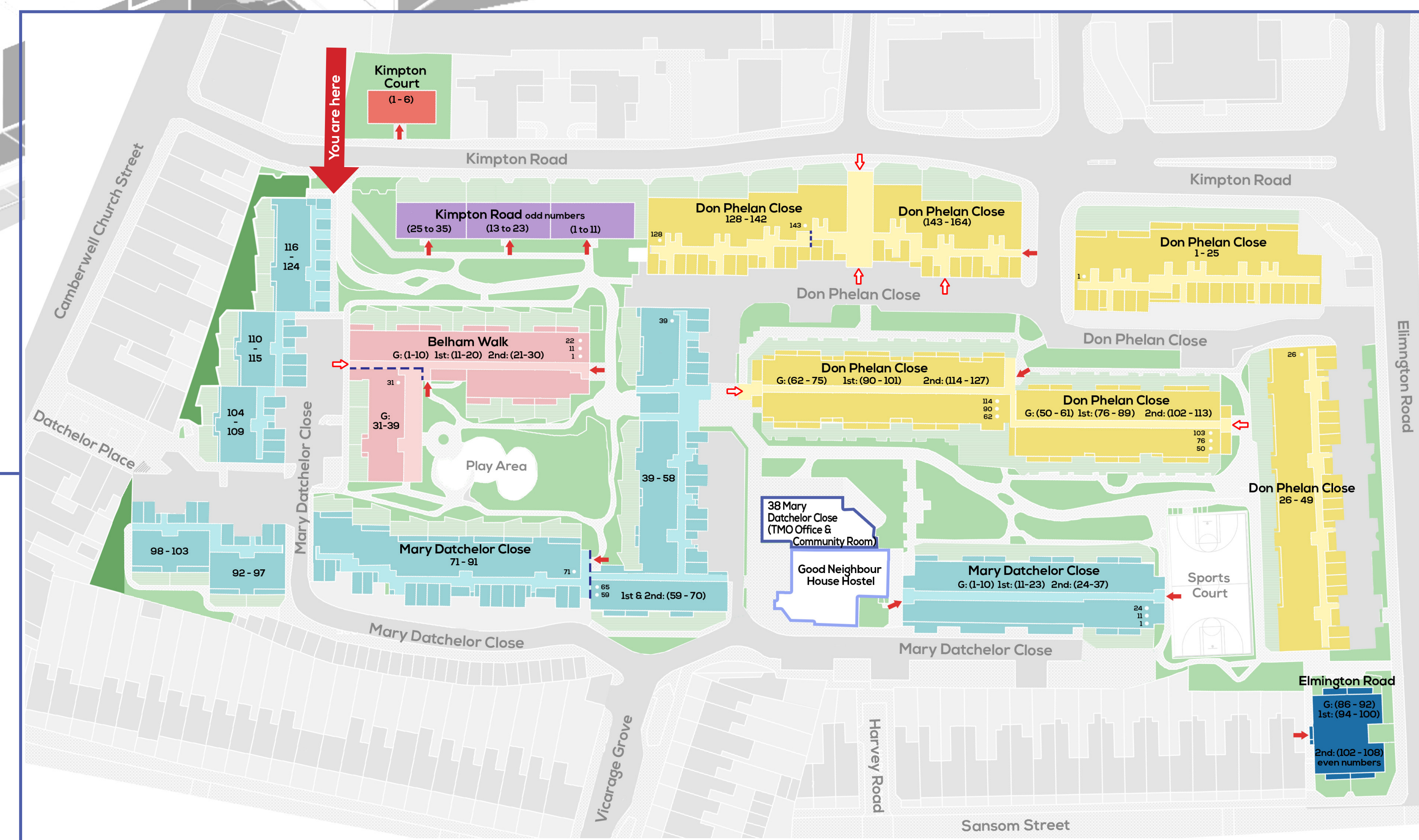
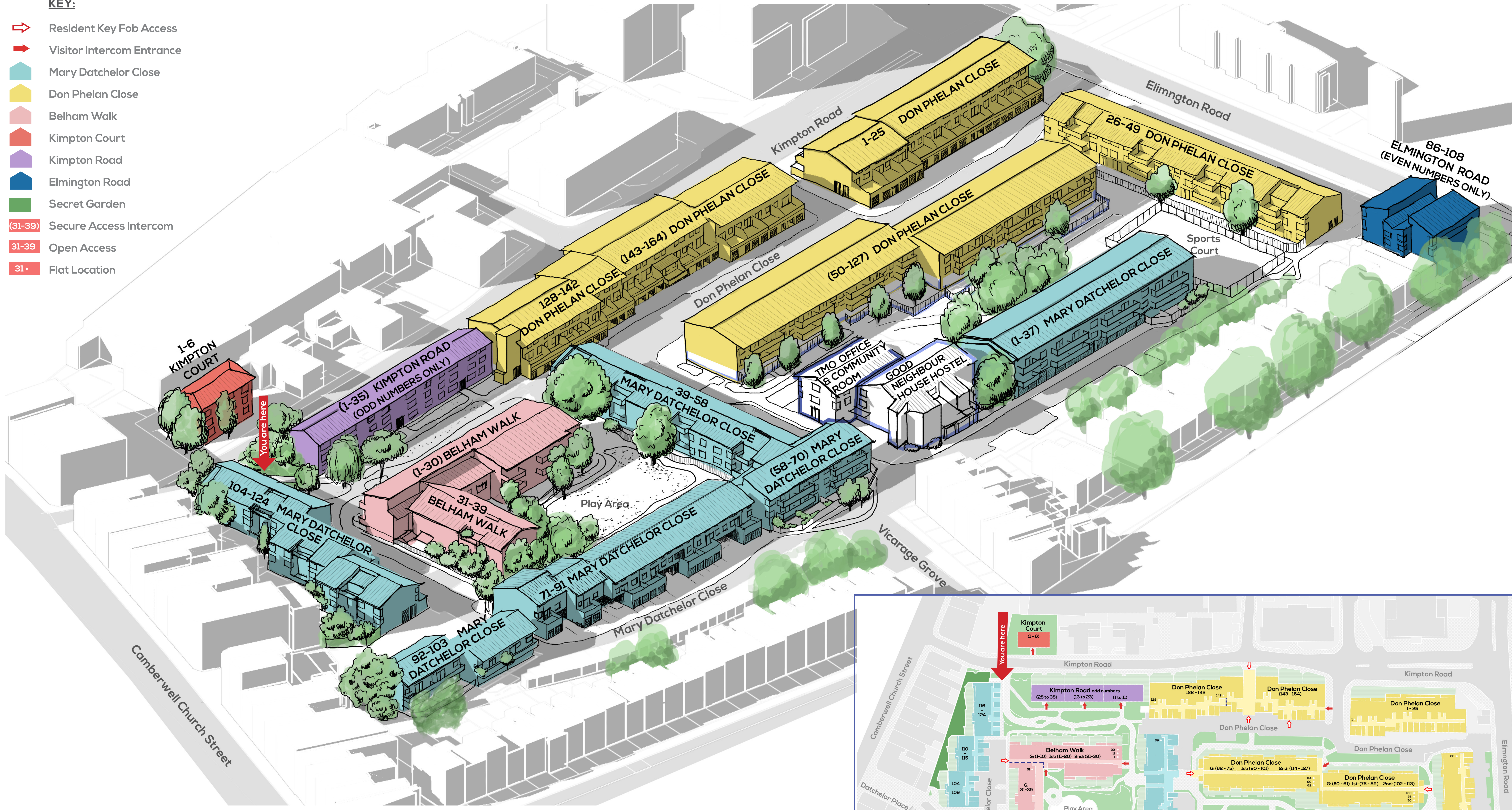

History of D'Eynsford Estate

The D'Eynsford Estate was designed by former RIBA vice-president Clifford Culpin in 1971. It was managed exclusively by Southwark Council until 2015 when D'Eynsford Tenant Management Organisation (TMO) was set up to enable residents on the D'Eynsford Estate to take control of some estate services from Southwark Council.



D'Eynsford Tenant Management Organisation
 Estate Office 38 Mary Datchelor Close, London, SE5 7AX,
 Tel: 020 7525 0745 | TMO@deynsford.org | www.deynsford.org

WELCOME TO THE D'EYNSFORD ESTATE

KEY:

-  Resident Key Fob Access
-  Visitor Intercom Entrance
-  Mary Datchelor Close
-  Don Phelan Close
-  Belham Walk
-  Kimpton Court
-  Kimpton Road
-  Elmington Road
-  Secret Garden
-  (31-39) Secure Access Intercom
-  (31-39) Open Access
-  31 Flat Location

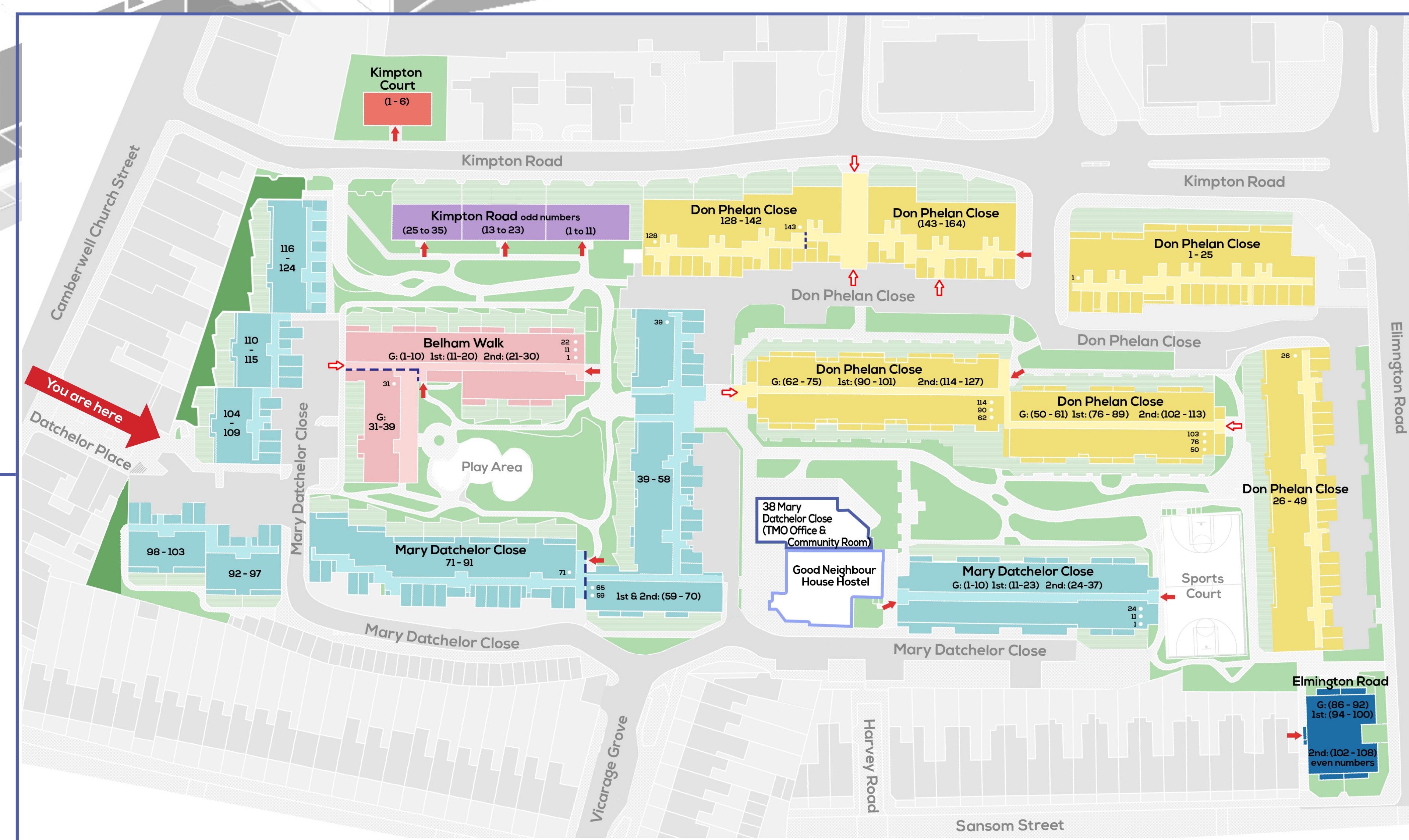
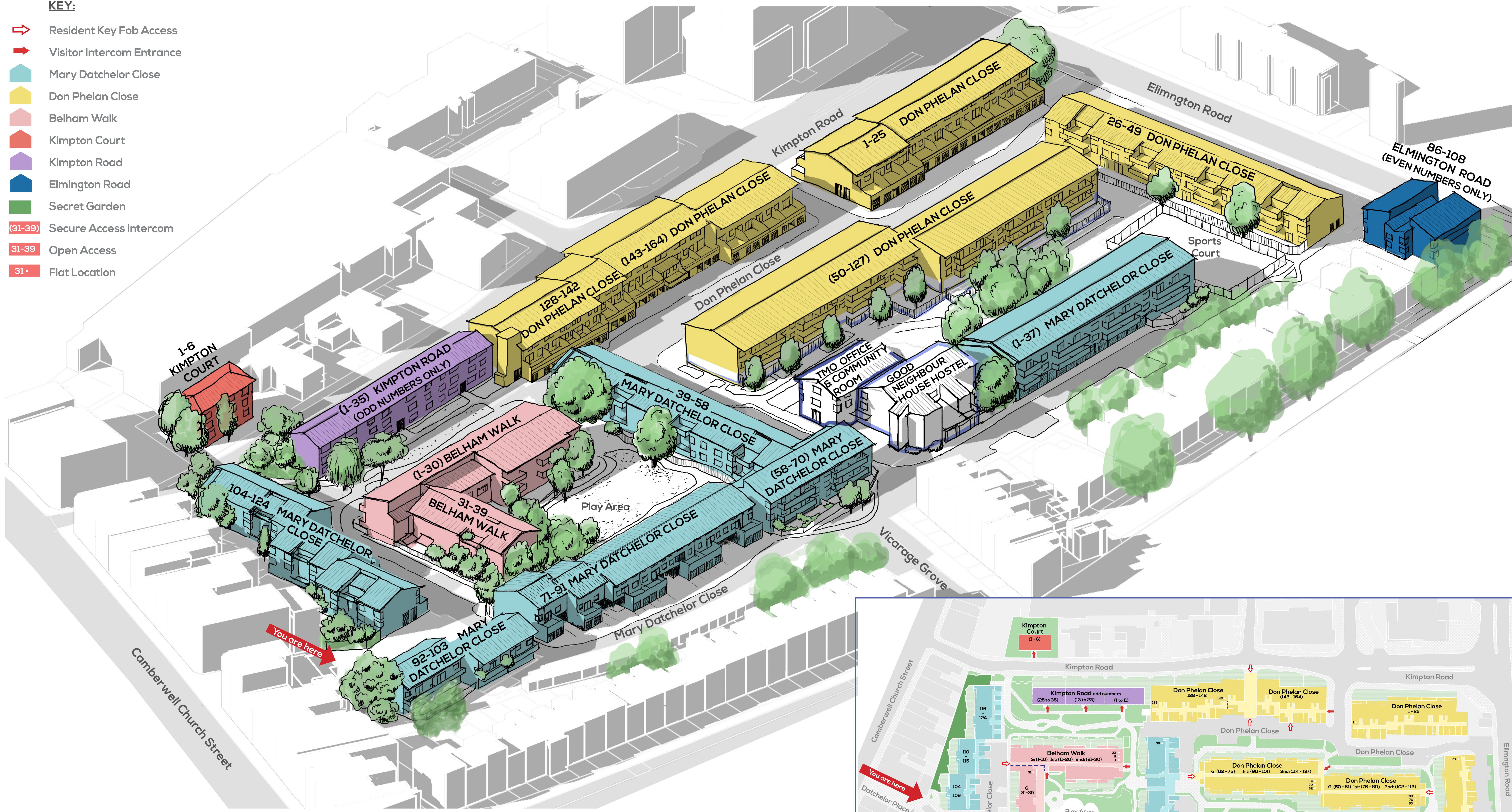

History of D'Eynsford Estate

The D'Eynsford Estate was designed by former RIBA vice-president Clifford Culpin in 1971. It was managed exclusively by Southwark Council until 2015 when D'Eynsford Tenant Management Organisation (TMO) was set up to enable residents on the D'Eynsford Estate to take control of some estate services from Southwark Council.

D'EYNSFORD



D'Eynsford Tenant Management Organisation

Estate Office 38 Mary Datchelor Close, London, SE5 7AX,
Tel: 020 7525 0745 | TMO@deynsford.org | www.deynsford.org

WELCOME TO THE D'EYNSFORD ESTATE

KEY:

-  Resident Key Fob Access
-  Visitor Intercom Entrance
-  Mary Datchelor Close
-  Don Phelan Close
-  Belham Walk
-  Kimpton Court
-  Kimpton Road
-  Elmington Road
-  Secret Garden
-  Secure Access Intercom
-  Open Access
-  Flat Location

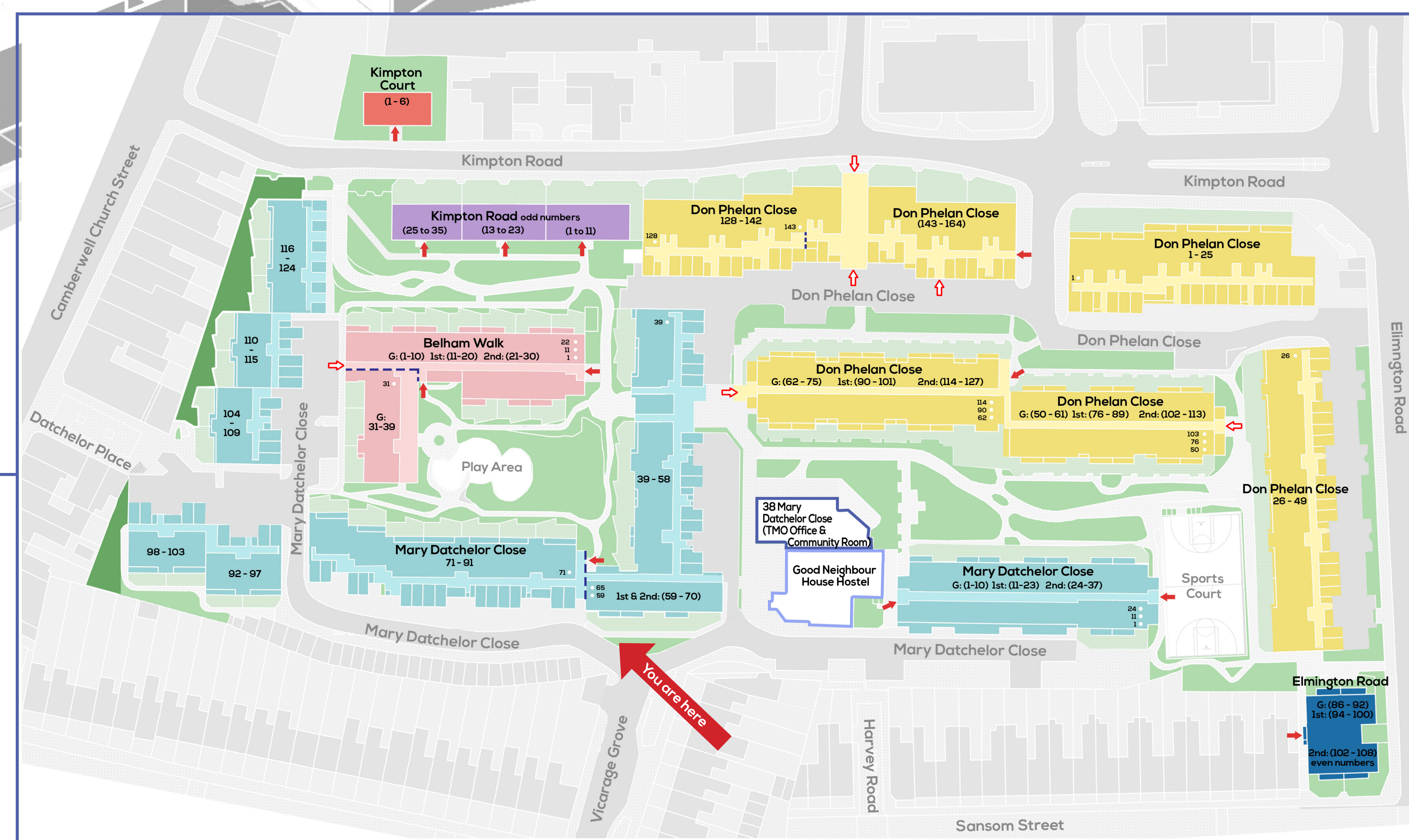
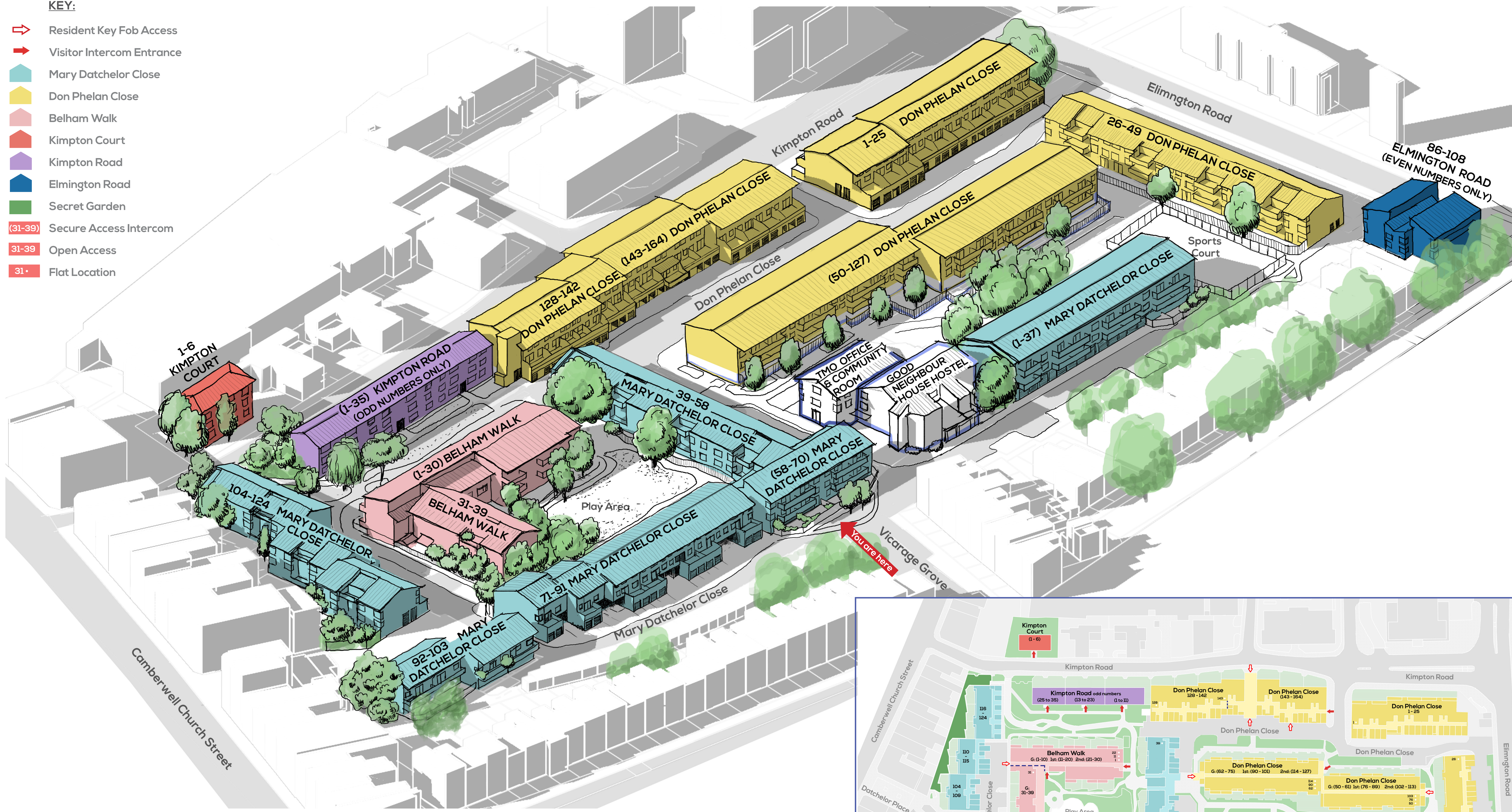

History of D'Eynsford Estate

The D'Eynsford Estate was designed by former RIBA vice-president Clifford Culpin in 1971. It was managed exclusively by Southwark Council until 2015 when D'Eynsford Tenant Management Organisation (TMO) was set up to enable residents on the D'Eynsford Estate to take control of some estate services from Southwark Council.

D'EYNSFORD



D'Eynsford Tenant Management Organisation

Estate Office 38 Mary Datchelor Close, London, SE5 7AX,
Tel: 020 7525 0745 | TMO@deynsford.org | www.deynsford.org

WELCOME TO THE D'EYNSFORD ESTATE

KEY:

-  Resident Key Fob Access
-  Visitor Intercom Entrance
-  Mary Datchelor Close
-  Don Phelan Close
-  Belham Walk
-  Kimpton Court
-  Kimpton Road
-  Elmington Road
-  Secret Garden
-  (31-39) Secure Access Intercom
-  (31-39) Open Access
-  31 Flat Location

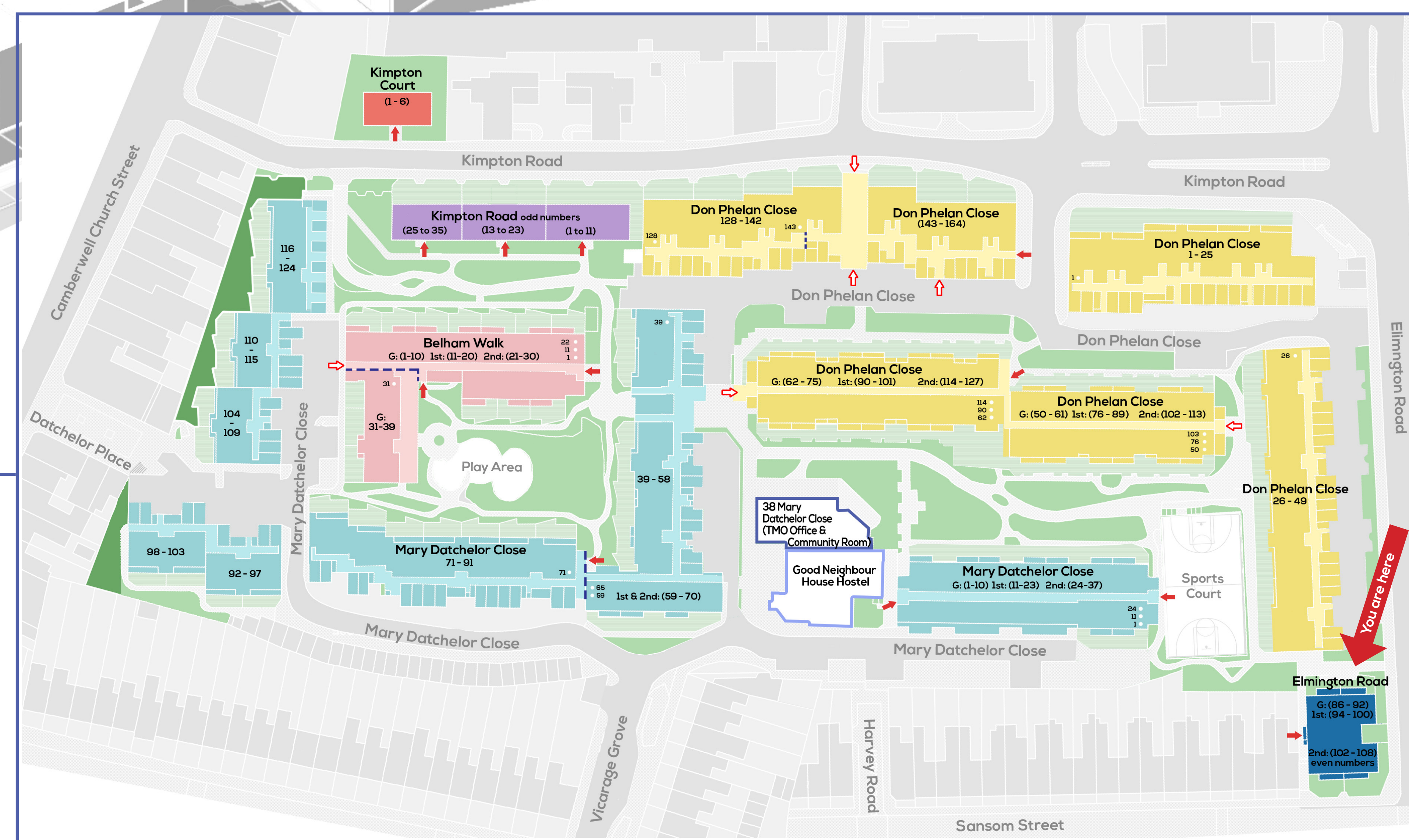
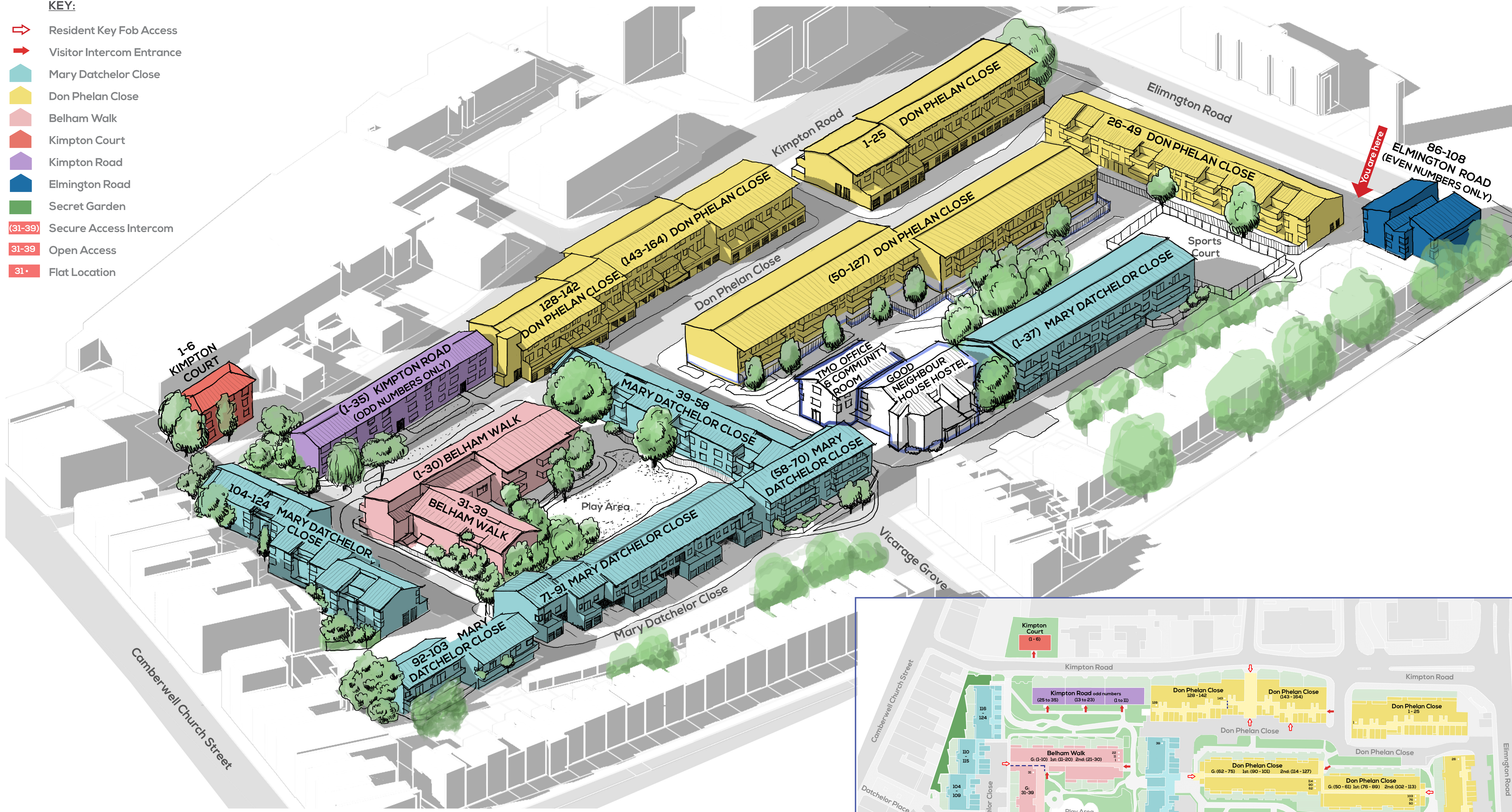

History of D'Eynsford Estate

The D'Eynsford Estate was designed by former RIBA vice-president Clifford Culpin in 1971. It was managed exclusively by Southwark Council until 2015 when D'Eynsford Tenant Management Organisation (TMO) was set up to enable residents on the D'Eynsford Estate to take control of some estate services from Southwark Council.

D'EYNSFORD



D'Eynsford Tenant Management Organisation

Estate Office 38 Mary Datchelor Close, London, SE5 7AX,
Tel: 020 7525 0745 | TMO@deynsford.org | www.deynsford.org

WELCOME TO THE D'EYNSFORD ESTATE

KEY:

-  Resident Key Fob Access
-  Visitor Intercom Entrance
-  Mary Datchelor Close
-  Don Phelan Close
-  Belham Walk
-  Kimpton Court
-  Kimpton Road
-  Elmington Road
-  Secret Garden
-  (31-39) Secure Access Intercom
-  31-39 Open Access
-  31 Flat Location

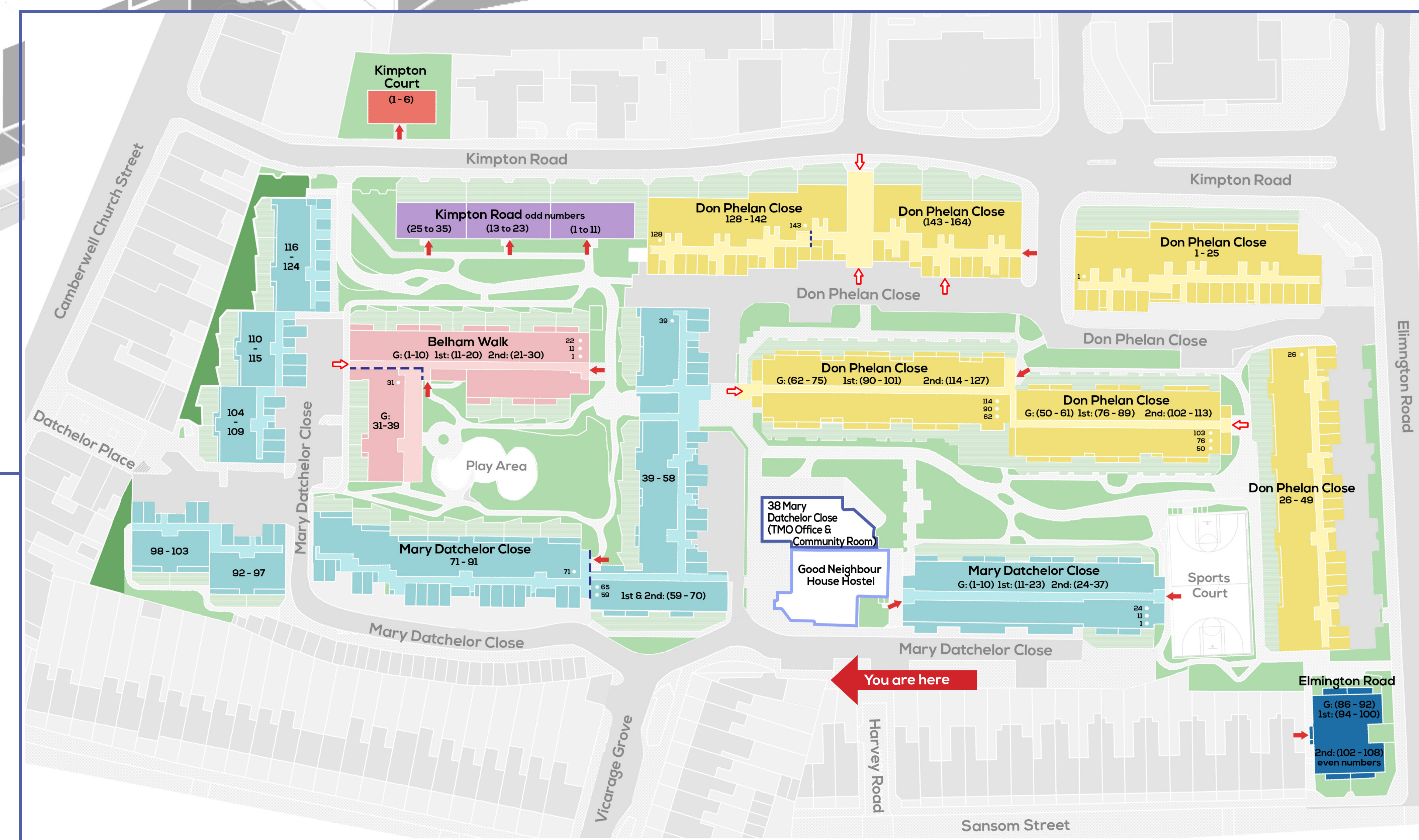
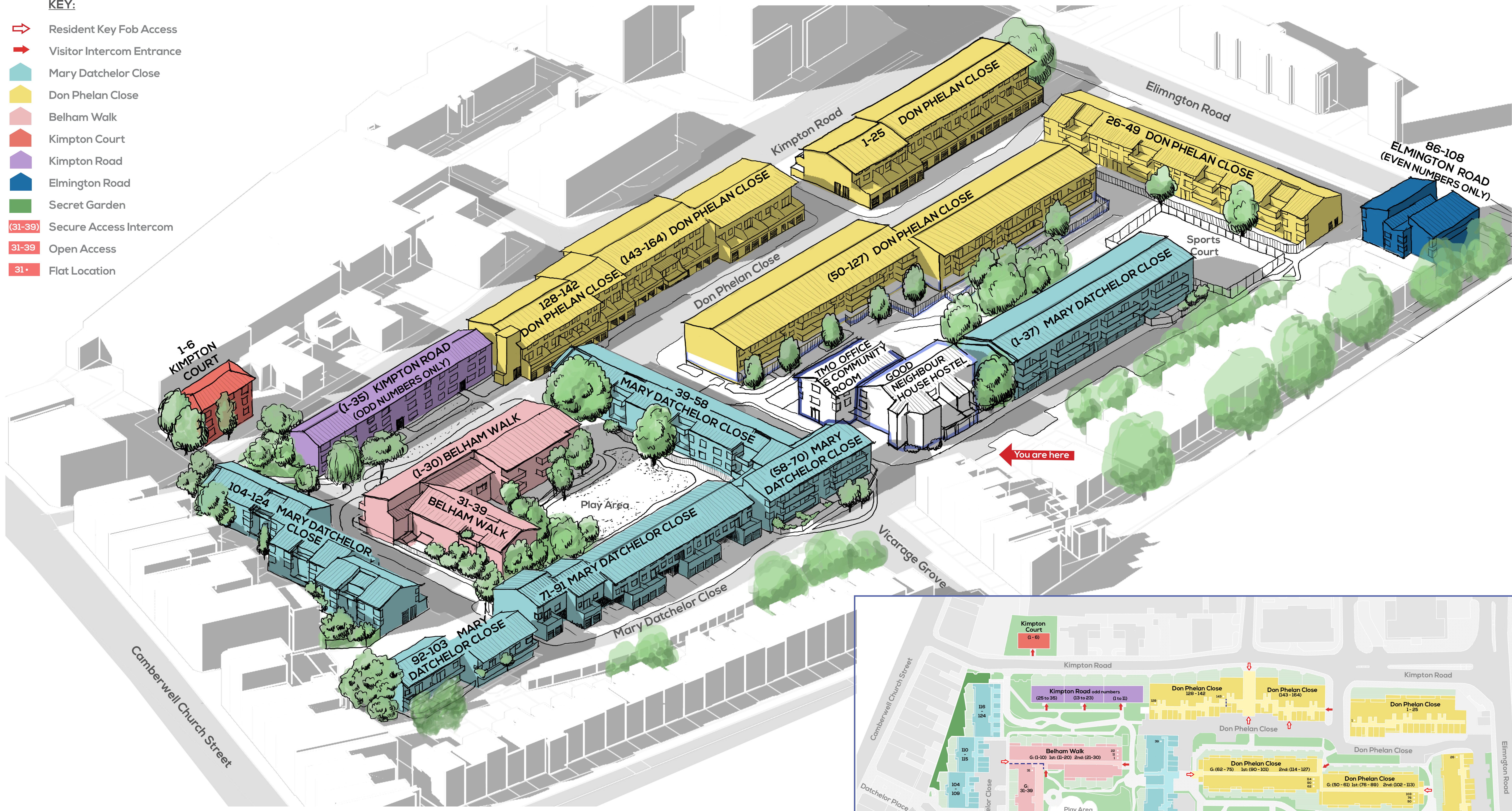

History of D'Eynsford Estate

The D'Eynsford Estate was designed by former RIBA vice-president Clifford Culpin in 1971. It was managed exclusively by Southwark Council until 2015 when D'Eynsford Tenant Management Organisation (TMO) was set up to enable residents on the D'Eynsford Estate to take control of some estate services from Southwark Council.



D'Eynsford Tenant Management Organisation

Estate Office 38 Mary Datchelor Close, London, SE5 7AX,
Tel: 020 7525 0745 | TMO@deynsford.org | www.deynsford.org